



jordan fishwick

Bridgemont Whaley Bridge High Peak



Bridgemont Whaley Bridge High Peak SK23 7PD

Reduced To £165,000



The Property

Close to the Peak Forest canal and conveniently located on the outskirts of Whaley Bridge, a spacious stone built mid terraced home. Offering well proportioned accommodation with two double bedrooms. Pvc double glazing with secondary glazing to the front, gas central heating and also comprising: living room with inglenook fireplace, dining kitchen, recently fitted ground floor family bathroom. Externally there is a tiered rear garden which is enclosed with a good degree of privacy . In the popular location of Bridgemont and next to a lovely village park. Viewing highly recommended.



- Well Presented Spacious Stone Terrace
- Two Double Bedrooms
- Private Rear Garden
- Recently Fitted Modern Bathroom
- Popular Village Location
- Ideal First Home or Downsize
- Close to Whaley Bridge Canal and Amenities

Postcode

SK23 7PD

EPC Rating

C

Local Authority

High Peak

Council Tax

A

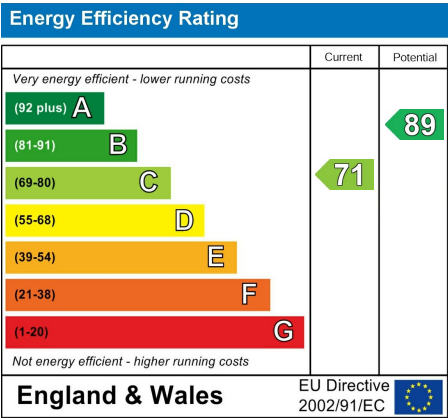

GROUND FLOOR

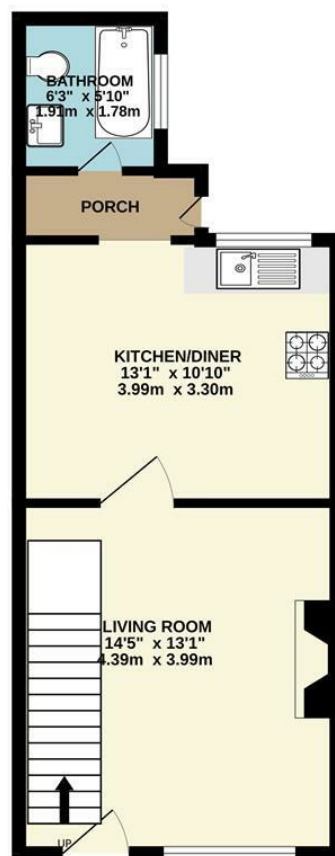

1ST FLOOR

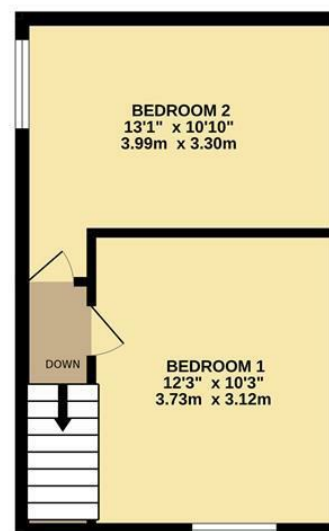

Whilst every attempt has been made to ensure the accuracy of the floorplan contained here, measurements of doors, windows, rooms and any other items are approximate and no responsibility is taken for any error, omission or mis-statement. This plan is for illustrative purposes only and should be used as such by any prospective purchaser. The services, systems and appliances shown have not been tested and no guarantee as to their operability or efficiency can be given.
Made with Metropix ©2024



These particulars are believed to be accurate but they are not guaranteed and do not form a contract. Neither Jordan Fishwick nor the vendor or lessor accept any responsibility in respect of these particulars, which are not intended to be statements or representations of fact and any intending purchaser or lessee must satisfy himself by inspection or otherwise as to the correctness of each of the statements contained in these particulars. Any floorplans on this brochure are for illustrative purposes only and are not necessarily to scale.

Offices at: Chorlton, Didsbury, Disley, Hale, Glossop, Macclesfield, Manchester Deansgate, Manchester Whitworth Street, New Mills, Sale, Wilmslow and Withington

2 Union Road, New Mills, High Peak, Derbyshire, SK22 3ES

01663 767878

newmills@jordanfishwick.co.uk

www.jordanfishwick.co.uk